

AUDITORIUM

DIMENSIONI PRINCIPALI

mq calpestabili	<i>mq</i>	1720
larghezza principale	<i>m</i>	32,82
lunghezza principale	<i>m</i>	50,42
h sotto trave	<i>m</i>	8,15
h sotto impianti	<i>m</i>	7,10
h sotto proiettori	<i>m</i>	5,55

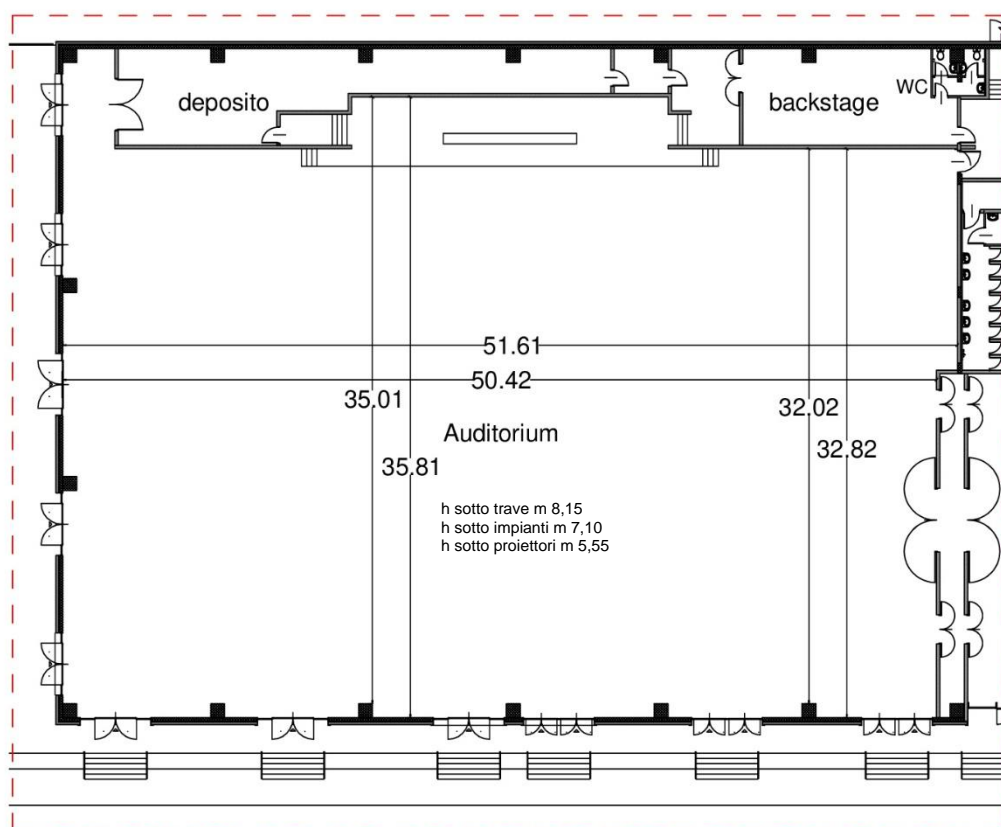
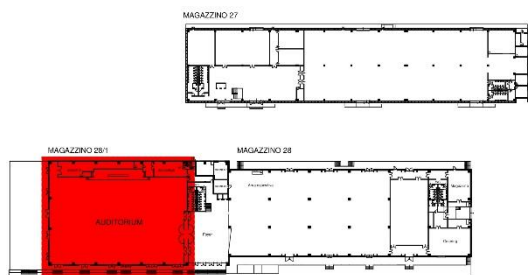

CONFIGURAZIONI E CAPIENZE

Platea – 1920 pax

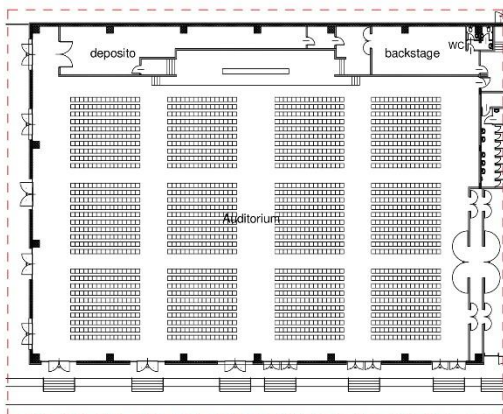

Platea COVID 50% – 960 pax

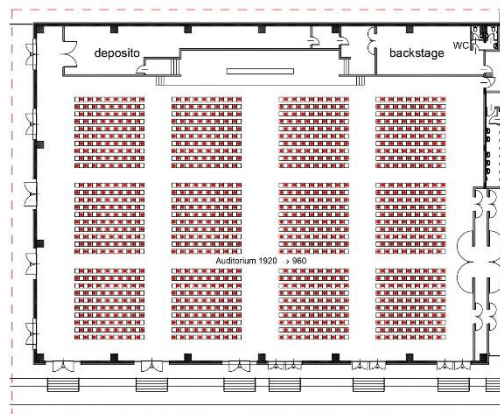

Riunione – 288 pax, tavoli 80x120 cm

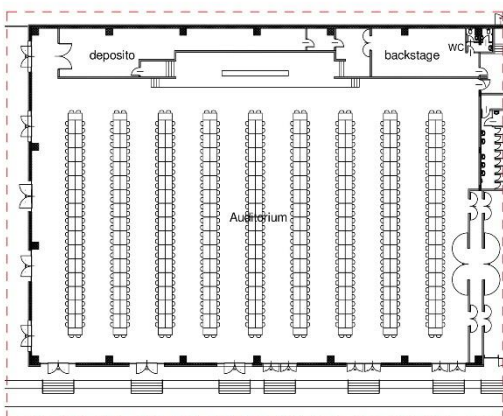

Ferro di cavallo – 114 pax, tavoli 80x120 cm

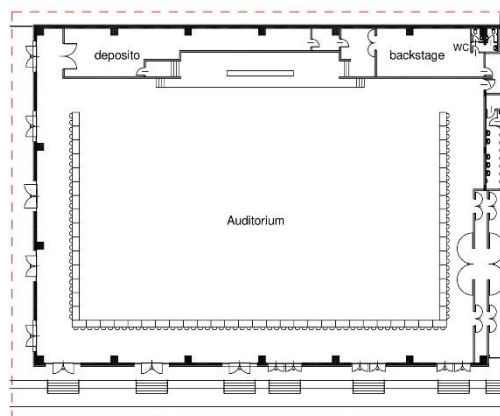

Banchi scuola – 864 pax, tavoli 50x120 cm

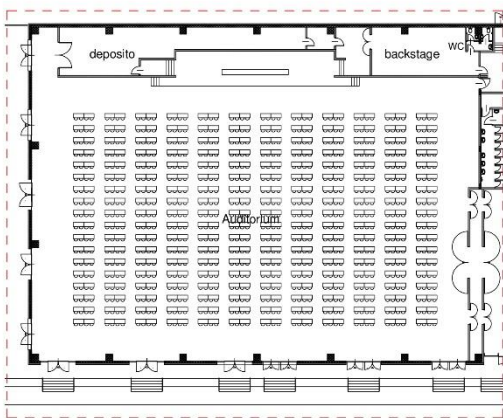

Banchetto – 896 pax, tavoli Ø 160 cm da 8 pax

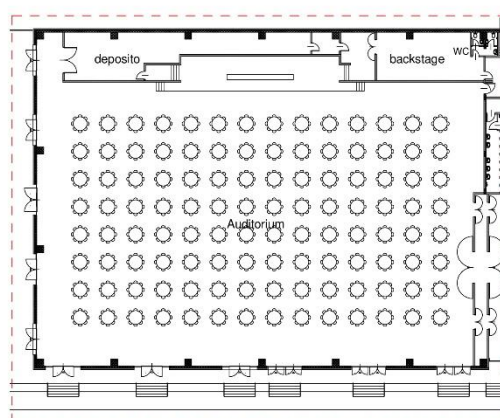

Reception – 1400 pax

