

SALA 272

DIMENSIONI PRINCIPALI

mq calpestabili	<i>mq</i>	268
larghezza principale	<i>m</i>	13,25
lunghezza principale	<i>m</i>	20,37
h controsoffitto	<i>m</i>	4,50

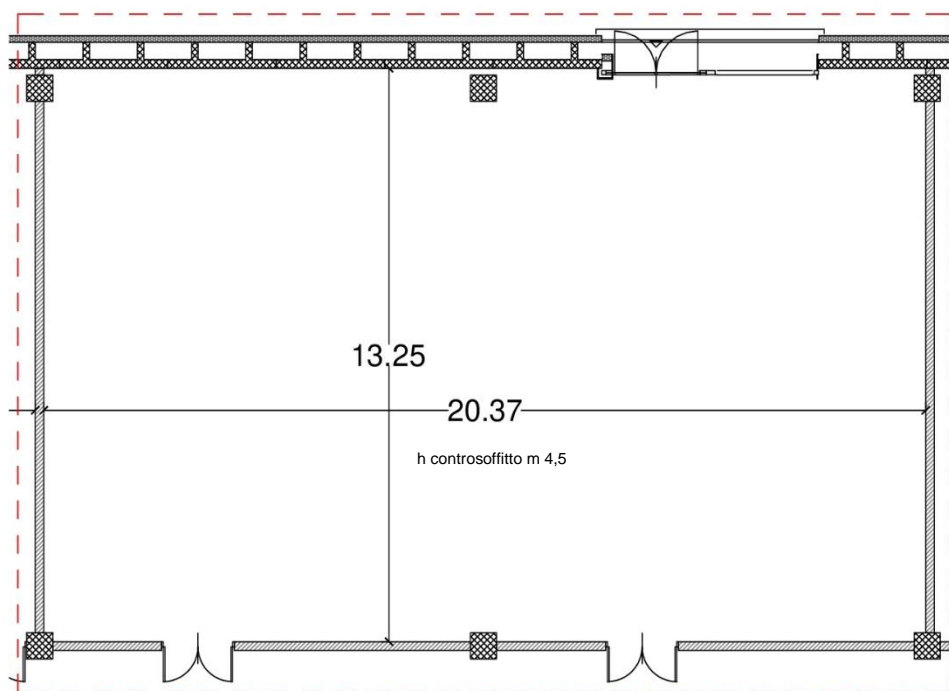
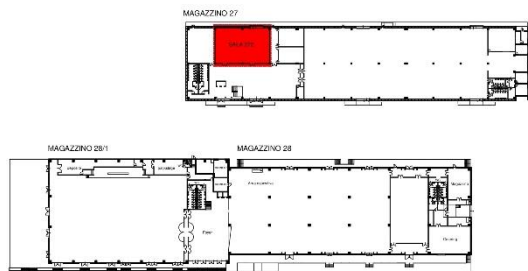

CONFIGURAZIONI E CAPIENZE

Platea – 272 pax

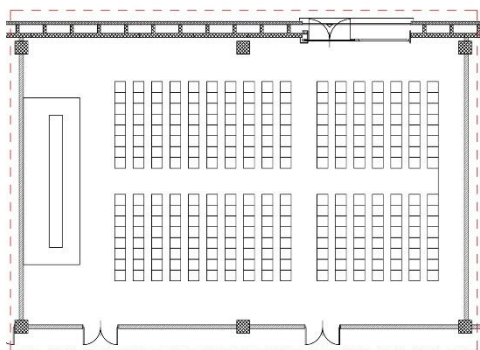

Platea COVID 50% – 136 pax

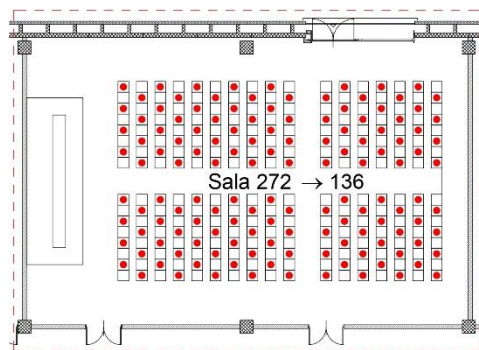

Riunione – 40 pax, tavoli 80x120 cm

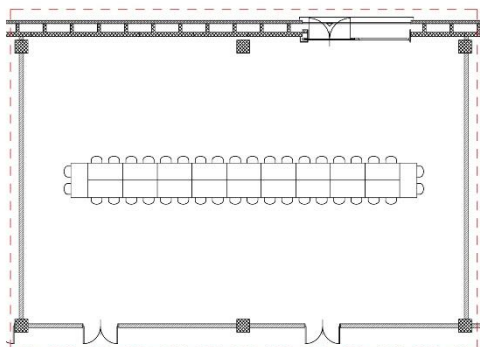

Ferro di cavallo – 48 pax, tavoli 80x120 cm

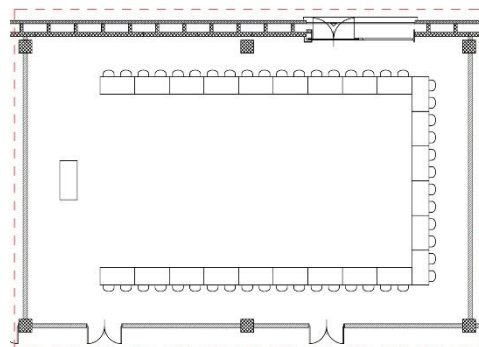

Banchi scuola – 144 pax, tavoli 50x120 cm

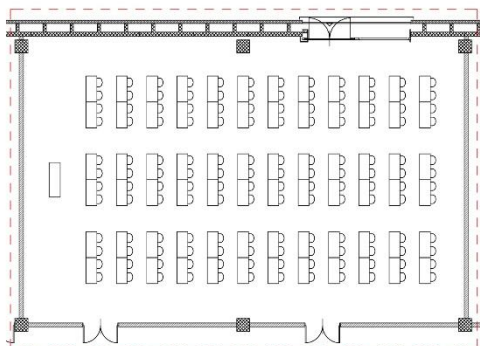

Banchetto – 144 pax, tavoli Ø 160 cm da 8 pax

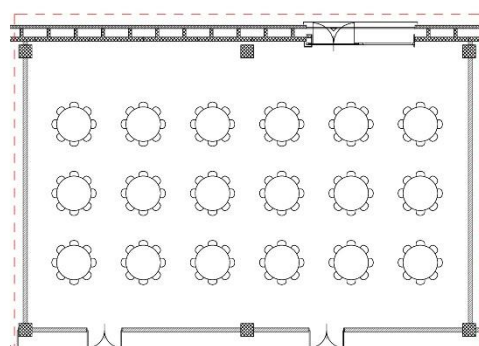

Reception – 234 pax