

## SALA 56 a

### DIMENSIONI PRINCIPALI

<b>mq calpestabili</b>	<i>mq</i>	65
<b>larghezza principale</b>	<i>m</i>	9,42
<b>lunghezza principale</b>	<i>m</i>	6,96
<b>h controsoffitto</b>	<i>m</i>	4,50

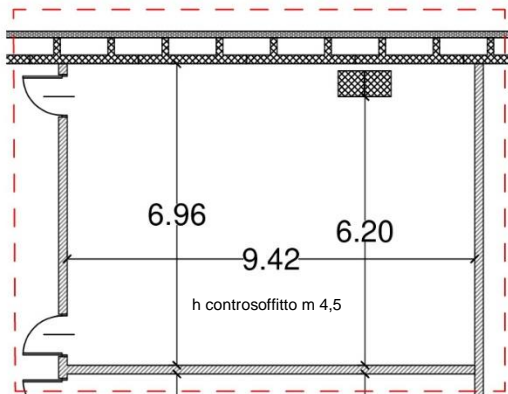
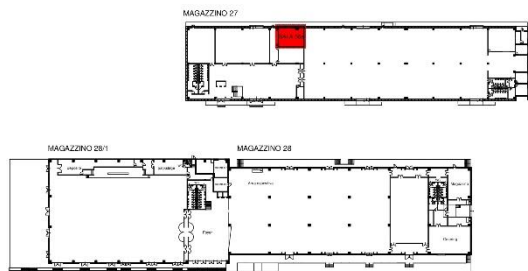

## CONFIGURAZIONI E CAPIENZE

**Platea – 56 pax**

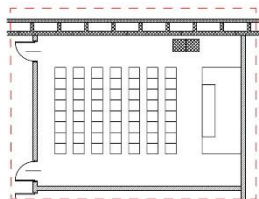

**Platea COVID 50% – 28 pax**

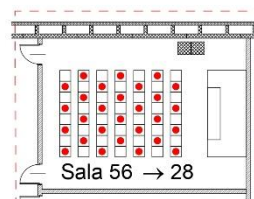

**Riunione – 16 pax, tavoli 80x120 cm**

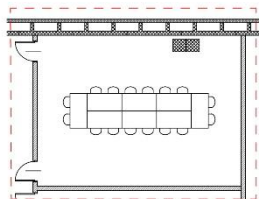

**Ferro di cavallo – 16 pax, tavoli 80x120 cm**

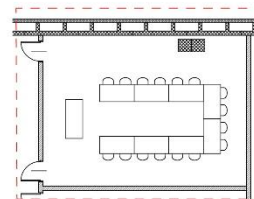

**Banchi scuola – 24 pax, tavoli 50x120 cm**

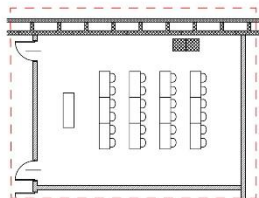

**Banchetto – 32 pax, tavoli Ø 160 cm da 8 pax**

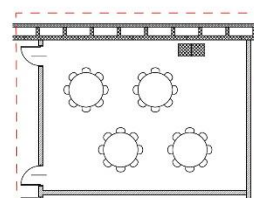

**Reception – 40 pax**